

911 SIGNAL[®]

Your innovative and
Reliable partner

911 SIGNAL TECHNOLOGY INC.

Tel: +86-574-89017911 +86-400-6757-911

Fax: +86-574-82822560 Email: sales@911signal.com

CN-Add: Room 701-702, Hengwei Building, No.258, Tiangao Lane, Shounan Subdistrict,
Yinzhou Area, Ningbo City, Zhejiang, China

EU-Add:19 rue Pierre Curie, 92400, Courbevoie,FRANCE

Email: euoffice@911signalgroup.com

Tel: +33(0)659163209

www.911signal.com

911 SIGNAL[®]

911 Signal
Vehicle Warning System

Your innovative and
Reliable partner

F3S

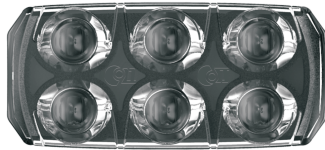

F6S

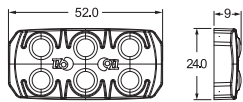

F3S

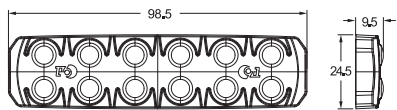

F6S

FEATURES

- Low profile with a robust structure and an artistic look
- Utilizes two rows of LEDs with 6 or 12 high-intensity diodes for superior warning effects
- Compact design offers multiple mounting locations
- Super fast installation with 3M adhesive or an optional bezel
- Fully encapsulated for moisture, vibration and corrosion resistance
- Synchronization capability

Model	Item	LED	Max Power	Voltage	Flash Patterns	Lens	Operating Temperature	Mount	Certification
F3S	023801	6pcs 3W	18W	DC 10-33V	19	TIR	-30 to 70°C	3M adhesive or Surface mount with chrome cover	SAE CA T13 ECE R65 R10
F6S	023901	12pcs 3W	36W		19				
	023902				12				

ORBIT C

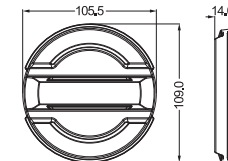
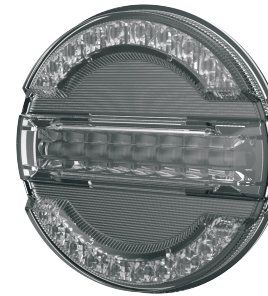

ORBIT C

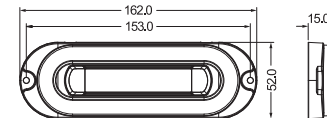

ORBIT U

ORBIT U

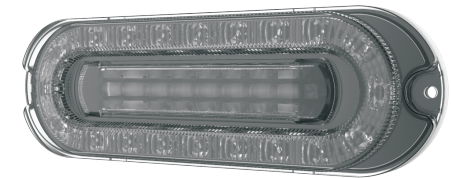

FEATURES

- Integration of warning, clearance, reversing and Stop / Tail / Turn lights - the first of its kind on the market
- Extremely innovative and recognizable three-dimensional design makes the product stand out among others
- Able to replace other products with 4" and 6" industry standard dimensions
- Warning light available in single color
- IP69K rated

Model	Item	LED	Max Power	Voltage	Flash Patterns	Lens	Operating Temperature	Mount	Certification
Orbit C	023501	32pcs 3W	16W	DC 10-33V	19	TIR	-30 to 70°C	Grommet mount or Surface mount with chrome cover	SAE J595, CA 13, R65, R7, R91, FMVSS-108
Orbit U	023701								

Your innovative and
Reliable partner

CRESCENT

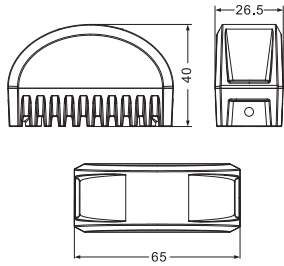

FEATURES

- 911 Signal exclusive Family C design with diamond-cutting techniques
- The most compact warning light to be certified under ECE R65 Class 2 regulations
- Versatile mounting options with specially designed brackets
- Solid and durable structure provides excellent weather resistance
- Effective heat dissipation prolongs lifespan
- IP69K rated



SIDEWINDER

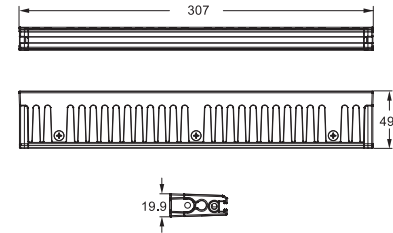

FEATURES

- Sleek and low-profile with high light intensity
- Extra wide lighting angle from 16° upwards and 8° downwards
- Utilizing modular design, the lengths can be customized from 1 to 6 modules, applicable for versatile vehicles including Ford, Dodge, Chevy etc
- Mortise and tenon joint design, quick and easy installation with brackets
- Foldable, minimized package reduces shipping cost and storage space
- Tough, anti-corrosive and water-resistant thermal plastic provides excellent heat dissipation
- Available in dual or triple colors
- IP69K



VISORMATE

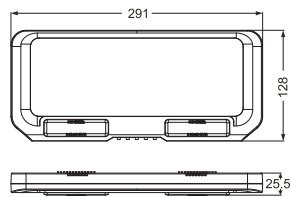

FEATURES

- Warning light available in single or dual colors
- 10-33V multi-voltage input
- Super fast mounting or dismantling with velcro tapes
- Customized text and color for different industries
- Adjustable backlight intensity for different scenarios
- ABS and UV-resistant frame assures long lifespan



RANA EYE

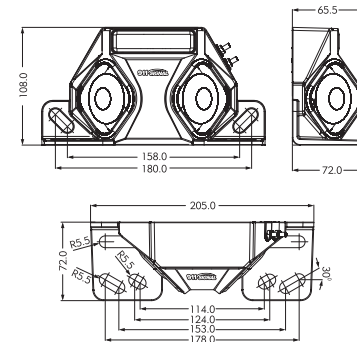

FEATURES

- Dual alarm system is utilized in case of malfunction
- Combination of audio and visual alerts with two back-up alarms and an integrated warning light
- A reserve-mounted speaker maximizes sound warning effect
- Universal mounting holes make it easy to install
- Reinforced nylon housing can resist 10G vibration
- Epoxy sealing protects the product from moisture, water or dust ingress



Model	Item	LED	Max Power	Voltage	Flash Patterns	Lens	Operating Temperature	Mount	Certification
Crescent	023601	16pcs 3W	24W	DC 10-33V	12	TIR	-30 to 70°C	Surface mount or Bracket mount	SAE, CA T13 ECE R65, R10
	023602	8pcs 3W							
Visormate	051901	8pcs 3W	12W(warning lights)	DC 10-33V	19	TIR	-30 to 70°C	Surface Mount	SAE, CA T13 R65 Class 1, R10
	052001	16pcs 3W	6W(backlight)						

Model	Item	LED	Max Power	Voltage	Flash Patterns	Lens	Operating Temperature	Mount	Certification
Sidewinder	041101	12pcs 3W	15W	DC 10-33V	16	LIN	-30 to 70°C	Bracket Mount	SAE J595, CA T13 ECE R65, R10
	041102	24pcs 3W							
	041103	36pcs 3W							
Ranaeye	091301	8pcs 3W	6W(Warning light) 2W(Back-up alarm)	DC 10-33V	19	TIR	Bolt Mount	SAE J994(back-up alarm) SAE J595, CA Title 13, ECE R65 and R10 (warning light)	

Your innovative and
Reliable partner

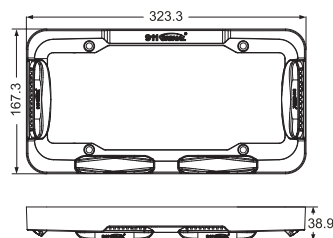

FEATURES

- 10-33V multi-voltage input
- Universal fit for all vehicles (sedan, SUV, pick-up truck etc) with a 12"x 6" license tag
- Water-proof connector provided for easy installation
- LED modules available in single, split, and dual colors with a steadyburn function
- Maximum 180° visibility horizontally and 120° vertically
- Provides full protection to the license tag without obstructing the information on it
- Frame made from ABS, UV, heat, water and corrosion resistant
- Full encapsulated LED modules with moisture, vibration and corrosion resistance

Model	Item	LED	Max Power	Voltage	Flash Patterns	Lens	Operating Temperature	Mount	Certification
Xcope	023201	24pcs 3W	36W	DC 10-33V	19	TIR	-30 to 70°C	Surface Mount	SAE J595 Class 1 CA T13
	023202	48pcs 3W	44W		12				

ROUTEMASTER

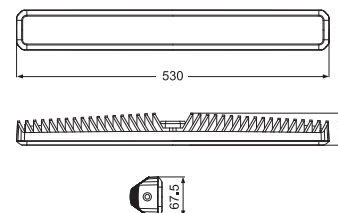

FEATURES

- Combination of warning and work light saves installation efforts and labor cost
- Integration of high and low beams; unique lens offers 8°, 40°, 60° and 180° lighting angles; adjustable light intensity
- Color temperature of work light reaches 6000K, bright enough and friendly to eyes
- Screwless design with an incredibly robust, beautiful and energetic look
- A pair of specially designed brackets are included for fast and secure mount
- Optional switch panel available for On/Off and flash pattern selection of warning light, and adjustment of light angle and intensity of work light
- IP69K rated

Model	Item	LED	Max Power	Voltage	Flash Patterns	Lens	Operating Temperature	Mount	Certification
Routemaster	140101	61pcs 3W	183W	DC 10-33V	12	TIR	-30 to 70°C	Bracket Mount	R10